

F. EXAMPLE PROJECTS WHICH BEST ILLUSTRATE PROPOSED TEAM'S QUALIFICATIONS FOR THIS CONTRACT <i>(Present as many projects as requested by the agency, or 10 projects, if not specified. Complete one Section F for each project.)</i>	20. EXAMPLE PROJECT KEY NUMBER 2
---	--

21. TITLE AND LOCATION <i>(City and State)</i>	22. YEAR COMPLETED	
High School Restructuring, New York, NY	PROFESSIONAL SERVICES 2014	CONSTRUCTION (if applicable) 2012

23. PROJECT OWNER'S INFORMATION

a. PROJECT OWNER New York City School Construction Authority	b. POINT OF CONTACT NAME Stanley Dahir	c. POINT OF CONTACT PHONE NUMBER 718-472-8740
---	---	--

24. BRIEF DESCRIPTION AND RELEVANCE TO THIS CONTRACT (INCLUDE SCOPE, SIZE, AND COST)

Under our **term contract** with the New York School Construction Authority, Gran Kriegel completed multiple task orders as part of an initiative to restructure large underperforming high schools into smaller "schools within schools". Work took place at locations throughout New York City, and included:

- Master plans
- Full A&E services for adaptive re-use of existing buildings
- Interior reconfiguration and renovation
- New science labs, classrooms, and administrative spaces
- Work on historic buildings
- Fire protection and M/E/P upgrades

With respect to the schools' **ongoing operations**, phasing plans were developed to accommodate summer construction.

Educational Campuses included:

- Erasmus Hall (historic building)
- Bushwick
- Far Rockaway
- Park West
- Prospect Heights
- Seward Park Campus
- Martin Luther King Jr.
- South Shore
- Springfield Gardens
- Samuel J. Tilden
- Thomas Jefferson
- Harry Van Arsdale
- George W. Wingate



The landmarked main hall and first floor plot and axions for Brooklyn's Erasmus Hall Educational Campus, one of 14 high schools restructured with Gran Kriegel as architect.

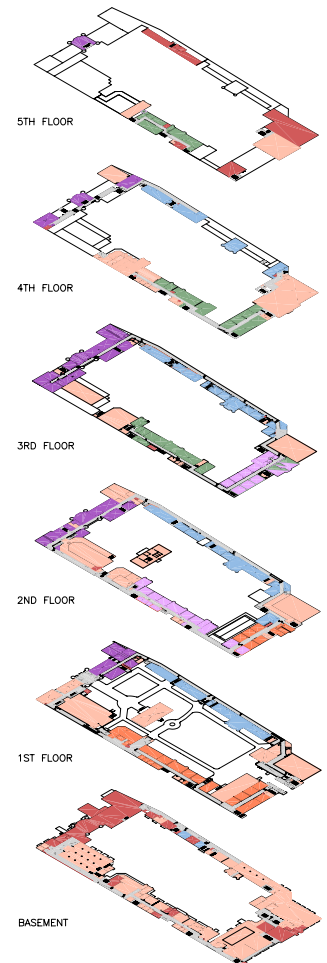

Relevance to Smithsonian IDIQ: Work orders under public sector term contract; master planning; space planning; report preparation; historic buildings; major and minor repairs; major renovations; adaptive re-use; high-traffic buildings

25. FIRMS FROM SECTION C INVOLVED WITH THIS PROJECT

	(1) FIRM NAME	(2) FIRM LOCATION <i>(City and State)</i>	(3) ROLE
a.	Gran Kriegel Associates	New York, NY	Architecture
b.	Dagher Engineering	New York, NY	M/E/P Engineering
c.	ConCost	East Orange, NJ	Cost Estimating